

Haylou GT6

True Wireless Earbuds
User Manual

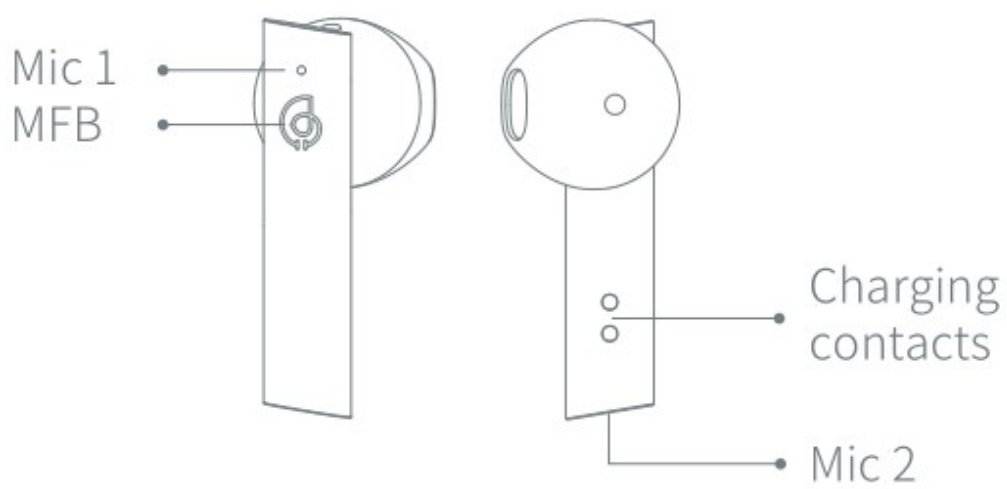

H A Y L O U





Gently insert the earbud into the ear canal, adjust the earbud to the most comfortable wearing state.

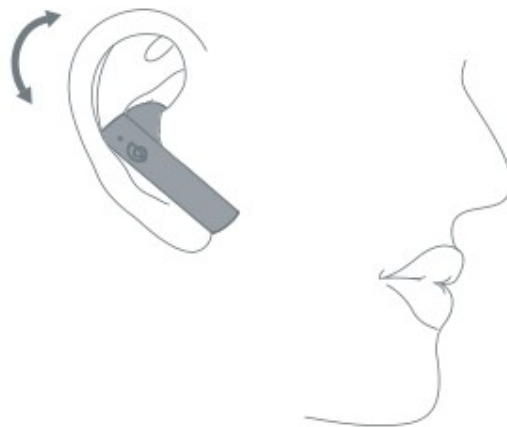

When calling, adjust Mic 2 towards mouth to gain better talking experience.

film on the charging contacts of both earbuds.
Then fully charge the charging case and earbuds.

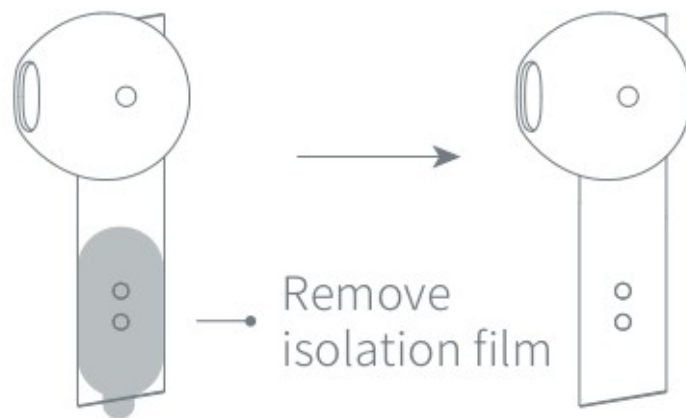

Plug in the charging cable to charge the earbuds
and the charging case at the same time.
The charging indicator light will be solid red
when the charging case is not fully charged.
The indicator light goes out after fully charged.

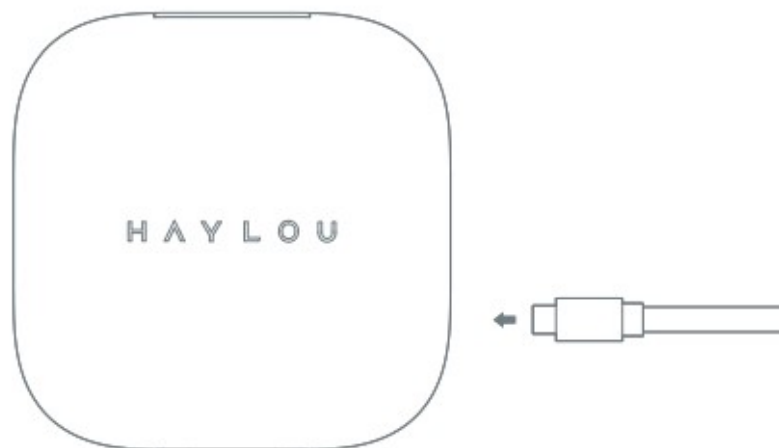

Power-on

Open lid to auto power on when the earbuds are in case.

If earbuds are out of case and in power-off state, keep touching the MFB button for about 1.5s to power on.

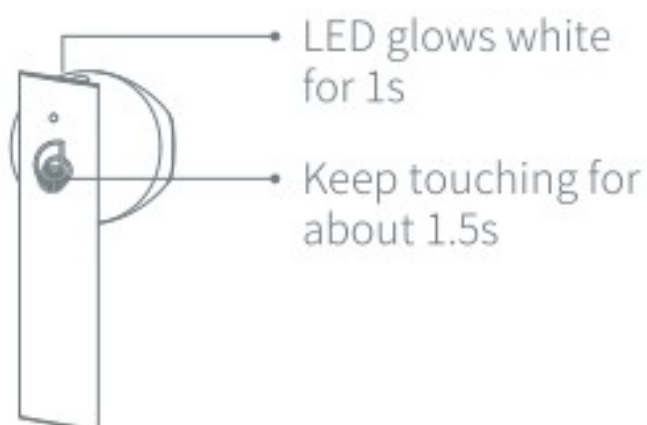

Power-off

Put back to charging case to auto power off earbuds. Keep touching the MFB button for about 4.5s when in power-on state.

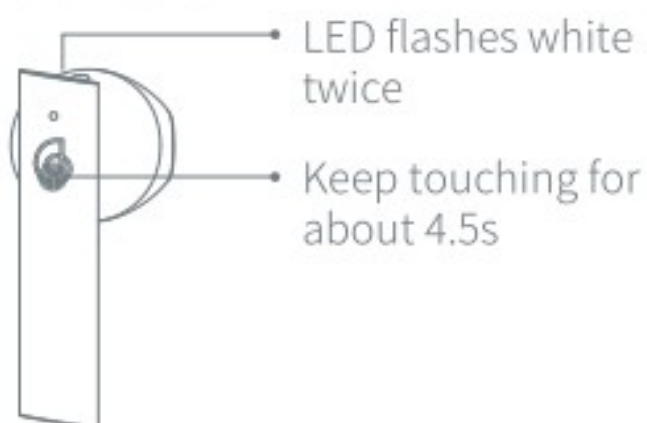

How to Pair

Take two earbuds out from the charging case simultaneously, then open device Bluetooth and search "Haylou GT6", finally click it to complete the connection.

Put the earbuds back to the charging case and repeat the above operation if the connection fails. After the first connection, the earbuds can be automatically connected to the last paired device (Bluetooth needs to be turned on).



Switch between mono and stereo mode: It is stereo mode after two earbuds are successfully connected. Put one back into the case to power off, the other will enter mono mode. Or pick it up again to resume stereo mode.

Manual connection: when earbuds are turned off, manually turn on both of them. Wait 2-3 seconds for them to turn on and connect to each other. Turn on device Bluetooth to connect when LED on both earbuds blink white slowly.

Functions

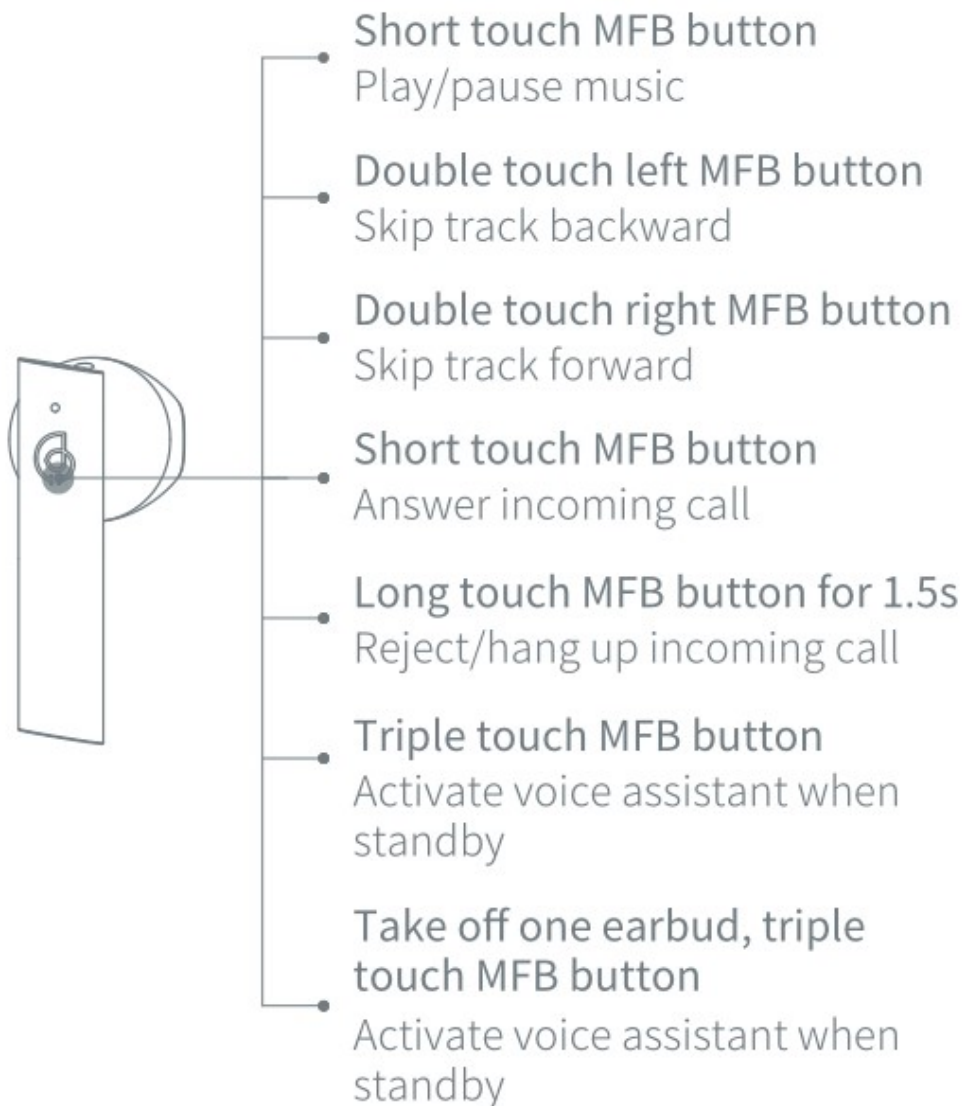

Factory Setting

1. Take out left and right earphones and long press the left and right earphone touch buttons at the same time for about 4s. Release after the light flashes white quickly and goes out;
 2. Long press the left and right earphone touch buttons at the same time for about 10s until the indicator lights up white constantly. Release after it goes out;
 3. Put the earphones back into the charging case and take them out again;
 4. Clear phone pairing records, follow the pairing steps to complete Bluetooth connection;
- * If the operation is unsuccessful, please repeat the above steps; or log in to the official flagship store, contact customer service to view reset operation video.

One of the Earbuds Mute

It's unusual indeed, please set earbuds to factory, remove connectivity record on phone and re-connect.

Other Charging Problems

1. White LED turns off after 30s. It means your earbuds have been fully charged.

2. The earbuds won't be charged if the charging case is out of power.
3. LED does not turn on when charging the case. It means that the case has been fully charged so the light does not turn on.

Package List

Earbuds, charging case, charging cable, user manual.

Basic Parameters(earbuds)

Operation range: 10m (open space with no obstacle)

Battery capacity: 35mAh(single earbud)

Charging time: approx. 2hr

Talk time: approx. 5hr

Standby time: approx. 50hr

Input parameter: 5V = 70mA

Battery type: li-ion

Bluetooth version: V5.2

Basic Parameters(charging case)

Input parameter: 5V = 500mA

Output parameter: 5V = 100mA

Charging time: approx. 2hr

Battery capacity: 310mAh

Battery type: li-ion

Caveats

Warning

1. Do not disassemble, repair or modify the product for any reason, as this may cause fire or even completely destroy the product.
2. Do not expose the product to environments where the temperature is too low or too high (below 0°C or above 45°C).
3. Keep the indicators away from the eyes of children and animals while using the earphones.
4. Do not use this product during thunderstorms. Thunderstorms may cause the product to malfunction and increase the risk of electric shocks.
5. Do not wipe and clean the earphones or their case with alcohol or other volatile liquids.
6. Avoid any contact with liquids.

Note

1. Please read this user manual carefully before using the product and please properly store it.
2. When using for the first time, please fully charge this product.
3. Please charge the product, in case it has not been used over two weeks.

FCC Requirement

changes or modifications not expressly approved by the party responsible for compliance could void the user's authority to operate the equipment.

This device complies with Part 15 of the FCC Rules. Operation is subject to the following two conditions:

- (1) this device may not cause harmful interference, and
- (2) this device must accept any interference received, including interference that may cause undesired operation.

Note: This equipment has been tested and found to comply with the limits for a Class B digital device, pursuant to Part 15 of the FCC Rules. These limits are designed to provide reasonable protection against harmful interference in a residential installation. This equipment generates, uses, and can radiate radio frequency energy, and if not installed and used in accordance with the instructions, may cause harmful interference to radio communications. However, there is no guarantee that interference will not occur in a particular installation. If this equipment does cause harmful interference to radio or television reception, which can be determined by turning the equipment off and on, the user is encouraged to try to correct the interference by one or more of the following measures:

- Reorient or relocate the receiving antenna.
- Increase the separation between the equipment and receiver.
- Connect the equipment into an outlet on a circuit different from that to which the receiver is connected.
- Consult the dealer or an experienced radio/TV technician for help.

2. Defects or physical damages caused by leaking or dropping off.
3. Damages by act of God.
Supposing your item is within any damages or defects except the above circumstances, please return to us or your distributor for free repairing.

Manufacturer: Dongguan Liesheng Electronic Co., Ltd.

Address: Room 401-410, Building 1, No.
86 Hongtu Road, Nancheng District,
Dongguan City, Guangdong, China